



# Mini Thin-Wall INSTALLATION INSTRUCTIONS

## STEP 1

Drill out the damaged threads to the diameter shown on the C-Sert packaging, and slightly deeper than the length of the C-Sert.

If possible, use a mag drill.

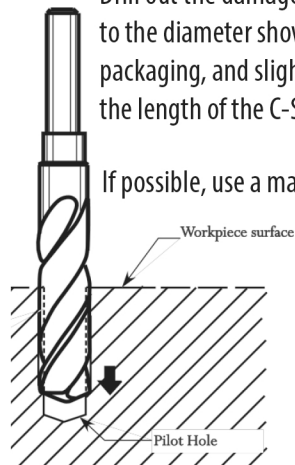

## STEP 2

Put the washer, then the nut, then the C-Sert onto the installer bolt. Next, turn the cylindrical guide COUNTER CLOCKWISE onto the bolt. Add plenty of cutting aid.

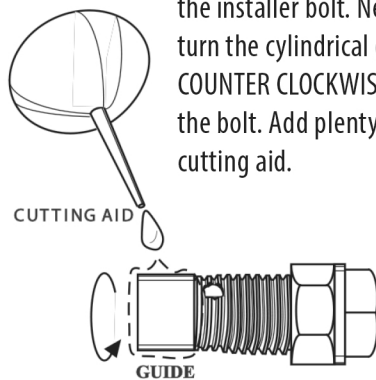

## STEP 3

Place the C-Sert assembly into the pilot hole, as deep as it will go. Turn the assembly clockwise only 2 or 3 full turns, to form guide threads.

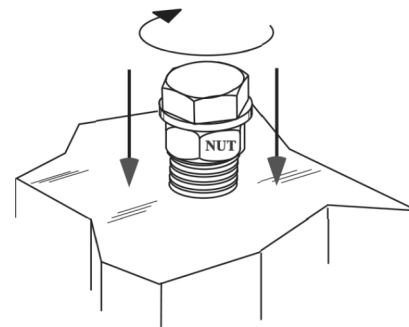

## STEP 4

Back the C-Sert assembly out of the pilot hole.

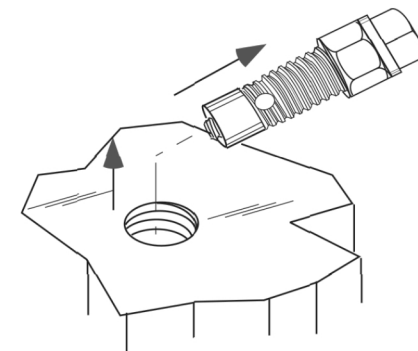

## STEP 5

Hold the bolt head with a wrench, and break the cylindrical guide free with the Allen wrench.

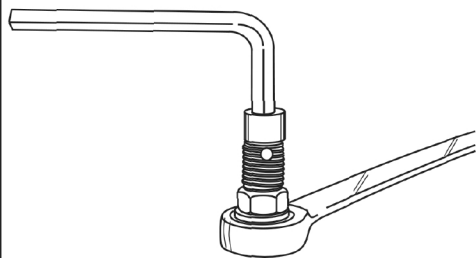

## STEP 6

Apply cutting aid to the C-Sert

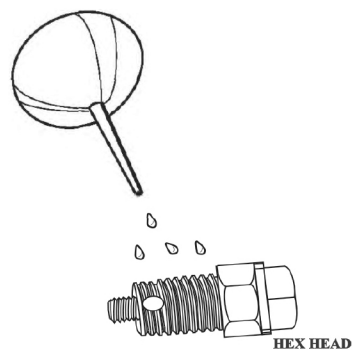

## STEP 7

Turn the C-Sert in manually so that it follows the pilot threads that you did in Step 3. Then turn the C-Sert in steadily until the installation nut shoulders up against the surface of the workpiece.

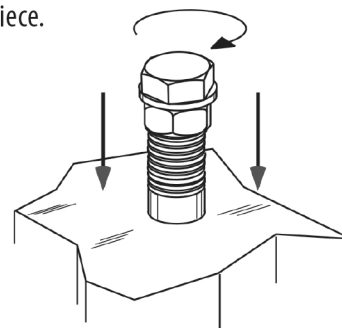

## STEP 8

When the nut has shouldered up against the surface of the workpiece, **secure it well** with a wrench, and then with a second wrench remove the installer bolt. Break up the chips inside the C-Sert and blow them out.

